



Blue Sky Network

Vehicular Push-To-Talk

VEHICULAR DOCKING STATION: IRIDIUM EXTREME AND PUSH-TO-TALK (PTT) IS AN ADVANCED IN-VEHICLE SOLUTION FOR SEAMLESS ON-THE-GO COMMUNICATIONS

Vehicular Docking Station: Iridium Extreme & PTT Installation Kit

Shown below are the components that ship with, or can be used with, the ASE-9575P-VEH kit.



DUAL-MODE ANTENNA

Low-profile, dual-mode Iridium and GPS antenna with 5 meter low-loss cable.



RUGGED 10-32VDC

Ruggedized connectors for wide-ranging power supplies.

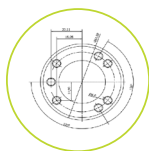

RAM VEHICLE MOUNTING

RAM mounting for flexible installation.

SUMMARY OF KEY FEATURES

- Provides in-vehicle solution for Iridium PTT
- Natural use with palm/speaker mic
- Rugged connectors for wide-ranging vehicle voltages: 9-32VDC
- Easy connection to vehicle antenna for Iridium and GPS
- Supports third-party PTT accessories
- Allows use of Iridium PTT while vehicle is moving
- No need to exit vehicle to communicate

Vehicular Docking Station: Iridium Extreme & PTT

ASE-9575P-VEH

Voltage	10-32 VDC	Cable or DC adapter
Power	12 Watts	Active peak
Antenna Connections	Iridium SMA-F	GPS SMA-F
Operating Temp	-10° to 55° C	
Dimensions	13 x 6 x 4.5 in.	33 x 15 x 11.5 cm
Weight	3.5 lb.	1.6 kg
Shipping Weight	6.0 lb.	2.7 kg
Shipping Dimensions	16 x 14 x 8 in.	41 x 36 x 20 cm



ADDITIONAL FEATURES & COMPONENTS



DUAL-ANTENNA OPTIONS

Magnetic low cost available. Dual-mode DMVA05 is recommended. Ships with 5 meter cable.



PTT COMPONENTS

Search for any S2 connector. Includes Bluetooth accessories.



RUGGED EXPANDABLE

Third-party headphones perfect for high-noise environment. Use S2 connectors.

Example antenna cable routing

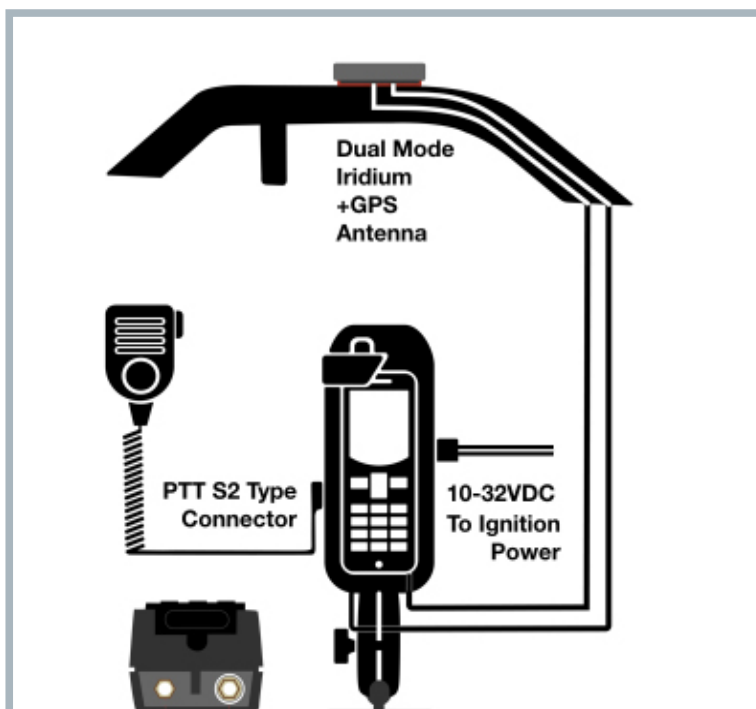
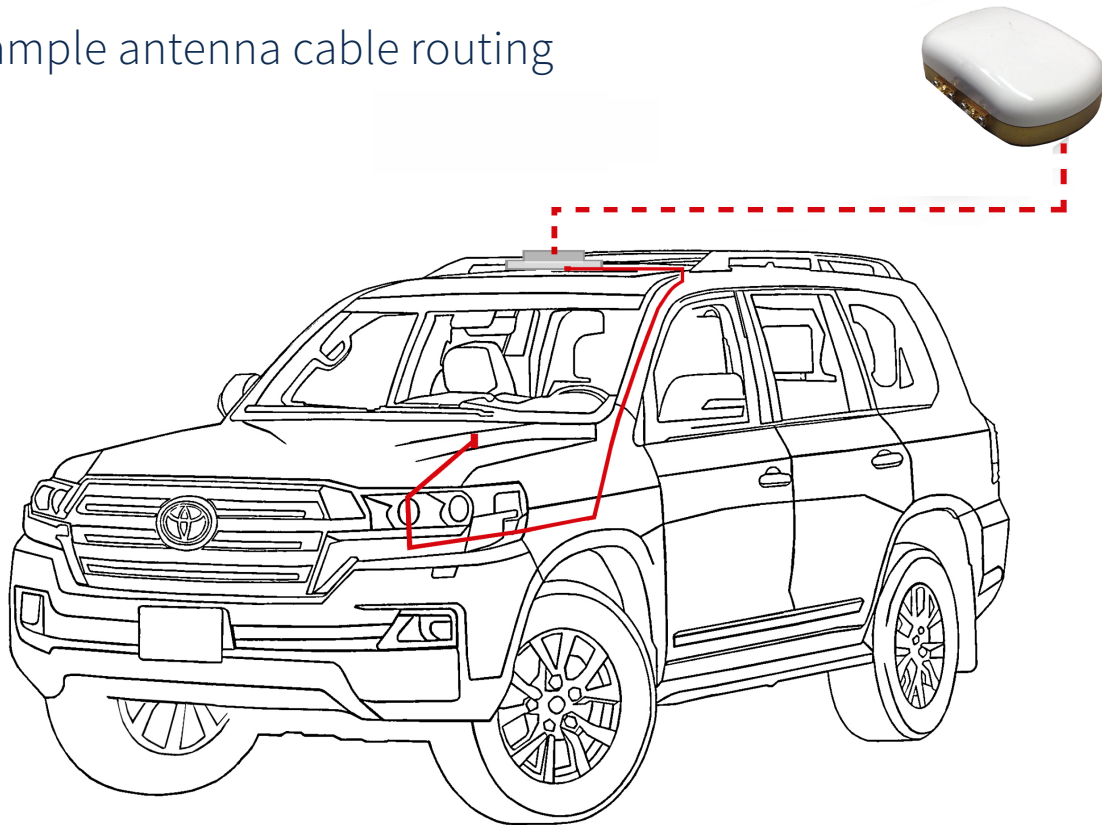

Diagram of connections



BagDock: Iridium 9575
PTT Enabled



BoxDock: Iridium 9575
PTT Enabled

Specifications and Shipping Information



9575P-VEH

Standard PTT Docking Station with POTS and GPS - Includes dock, RAM mount, fist speaker/mic

Harmonized Code - HTS#: 8518.30.2000 ECCN: EAR99

Shipping Dimensions: 16 x 14 x 8 in., 6 lb. (41 x 36 x 20 cm, 3 kg)

Additional Information

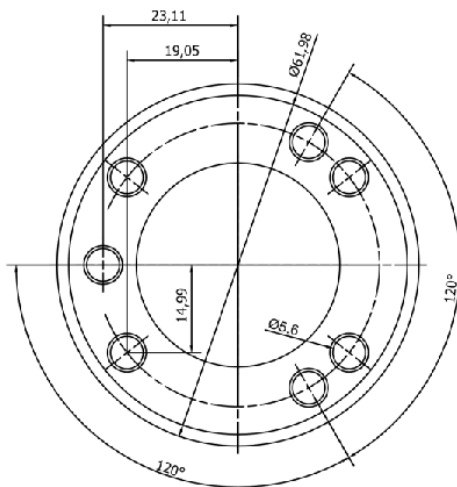

RAM MOUNTING - METRIC

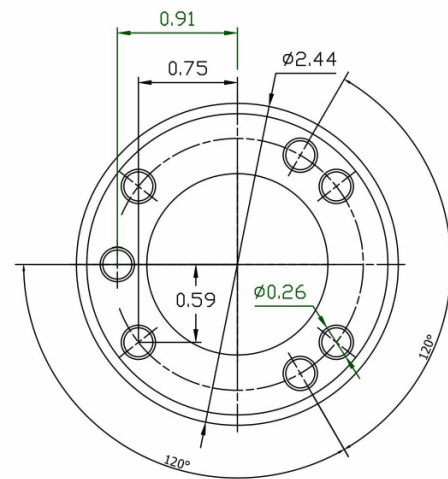

RAM MOUNTING - INCHES